

Concepts in Pictures 14

PRESS Black
PRESS Sheep

67, Middleton, Cowling, Keighley, W. Yorks. BD22 0DQ
Tel +44 (0)1535 631346, email: alan@blacksheeppress.co.uk

Big / Small

Big and Small

The concepts of BIG and SMALL should always be introduced using real objects, but it is often difficult to assemble, and keep together, a good range of materials.

Conversely, teaching big and small using pictures can be confusing for some children. For example, we tell them that an elephant is big... but represent it on a small piece of paper.

Our new set of pictures will hopefully be a useful intermediary resource for therapists and teachers. The pack consists of: -

- . A big teddy, a big cupboard, a big house and a big toy box
- . A small teddy, a small cupboard, a small house and a small toy box
- . Big and small pictures of clothes - jumper, shirt, jeans, pants, jacket, T-shirt, hat, scarf, boots.
- . Big and small pictures of furniture - chair, bed, T. V., table, bath, cooker, sofa, clock.
- . Big and small pictures of toys - book, doll, car, ball, pencils, toy dog, robot, space ship.

The pictures can be used for simple sorting games e.g. "Find the big car, find the little car", but instructions are provided to make up the cupboard, house and toy box into attractive 'Lift the flap' resources in which to post the pictures. All you need are scissors and sticky tape - no artistic ability is required.

The pack is also useful for semantic grouping games, teaching 'in' and, when photocopied several times and coloured in, a colour teaching game e.g. "Find the red shirt, put it in the red house, give the blue ball to the blue teddy" etc.

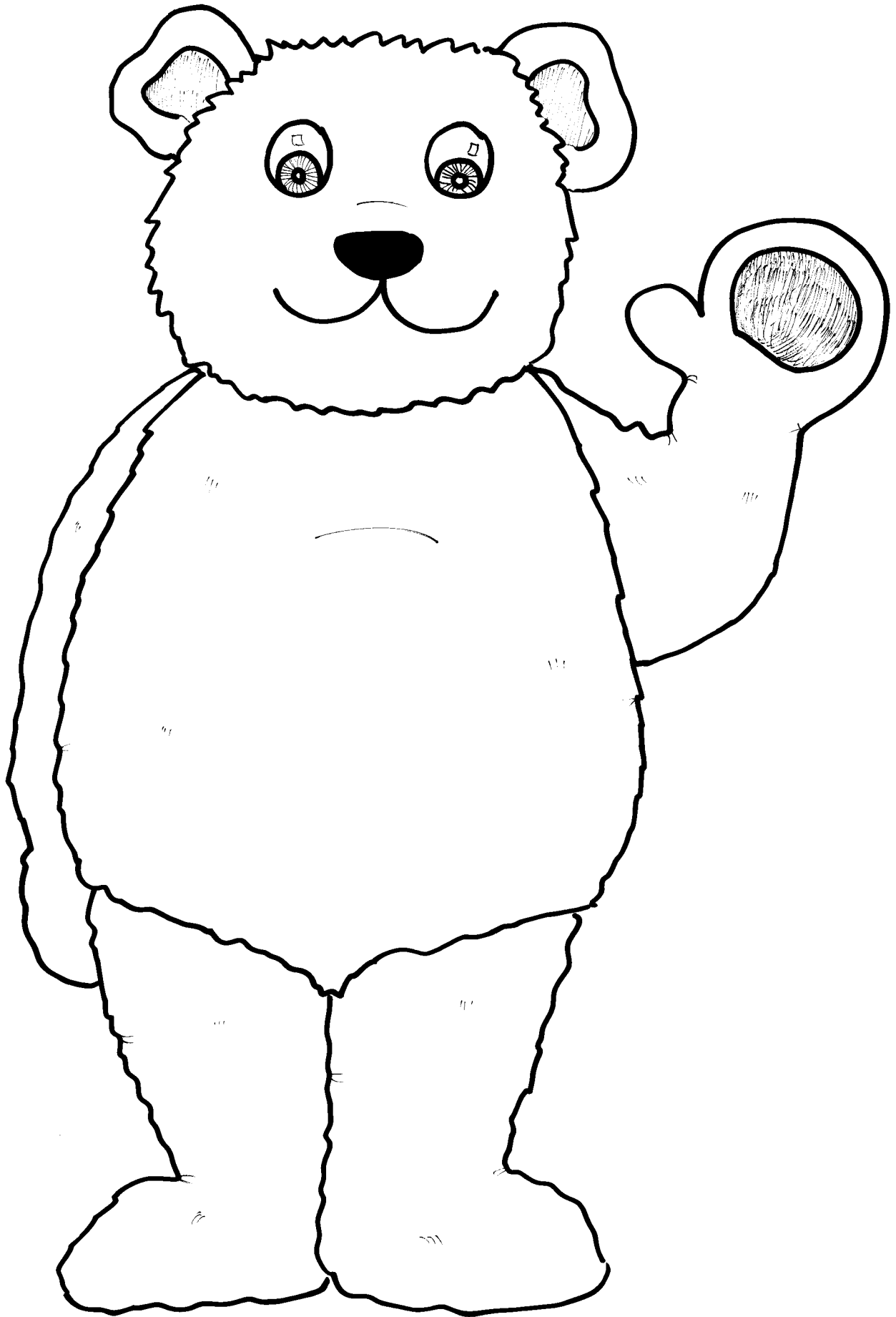

Cut along dotted lines

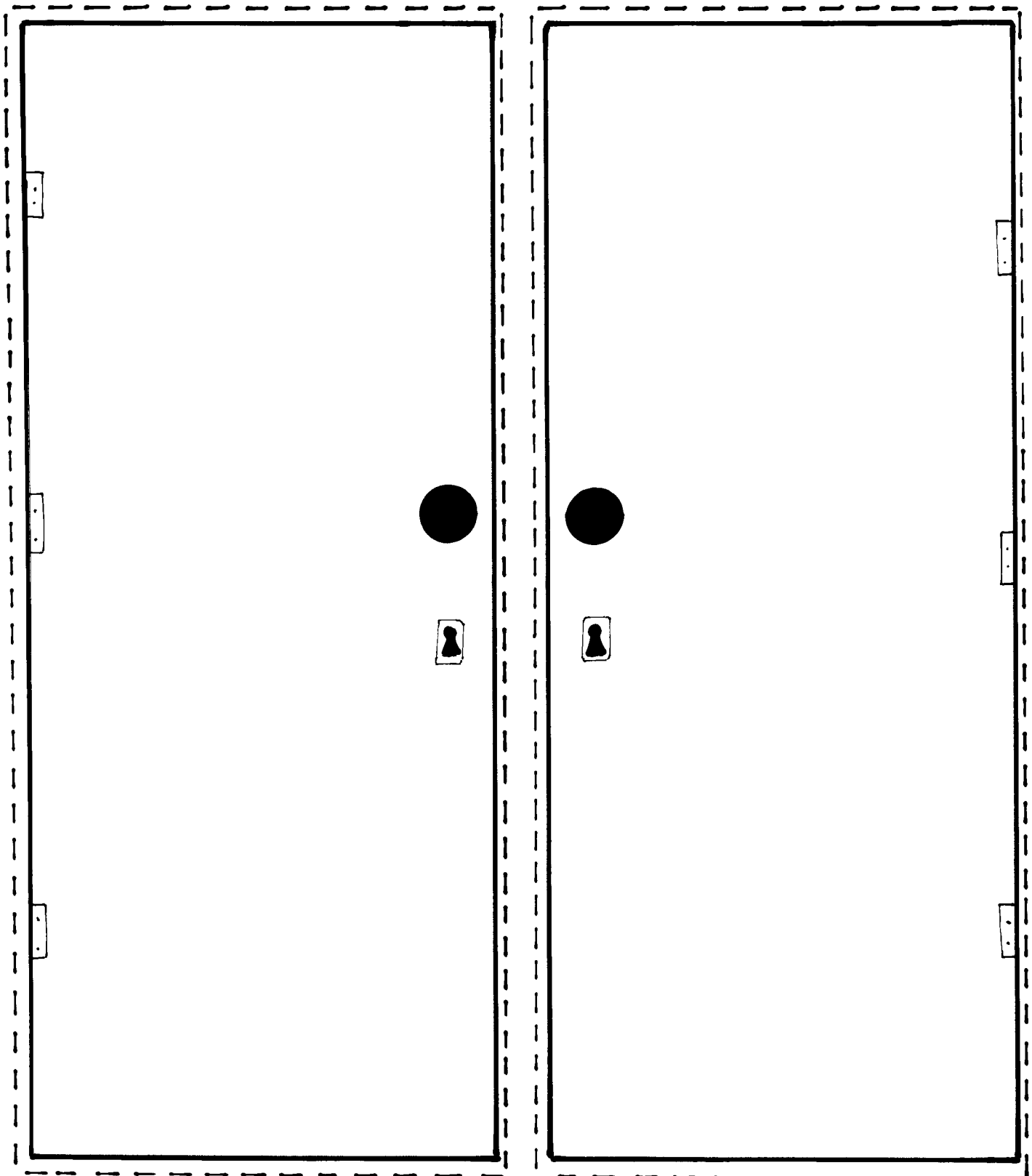

Cut out each door and place together on an A4 sheet of paper/card. Sellotape along "hinge" side of each door.

The cupboard doors will open and pictures can be placed inside.

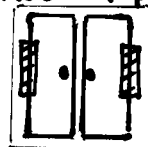

Cut out house and roof. Place house on a sheet of A4 paper/card, and place sticky tape along bottom and side edges. Position roof on house and tape along top edge only. The roof will then lift, to allow pictures to be posted into the house

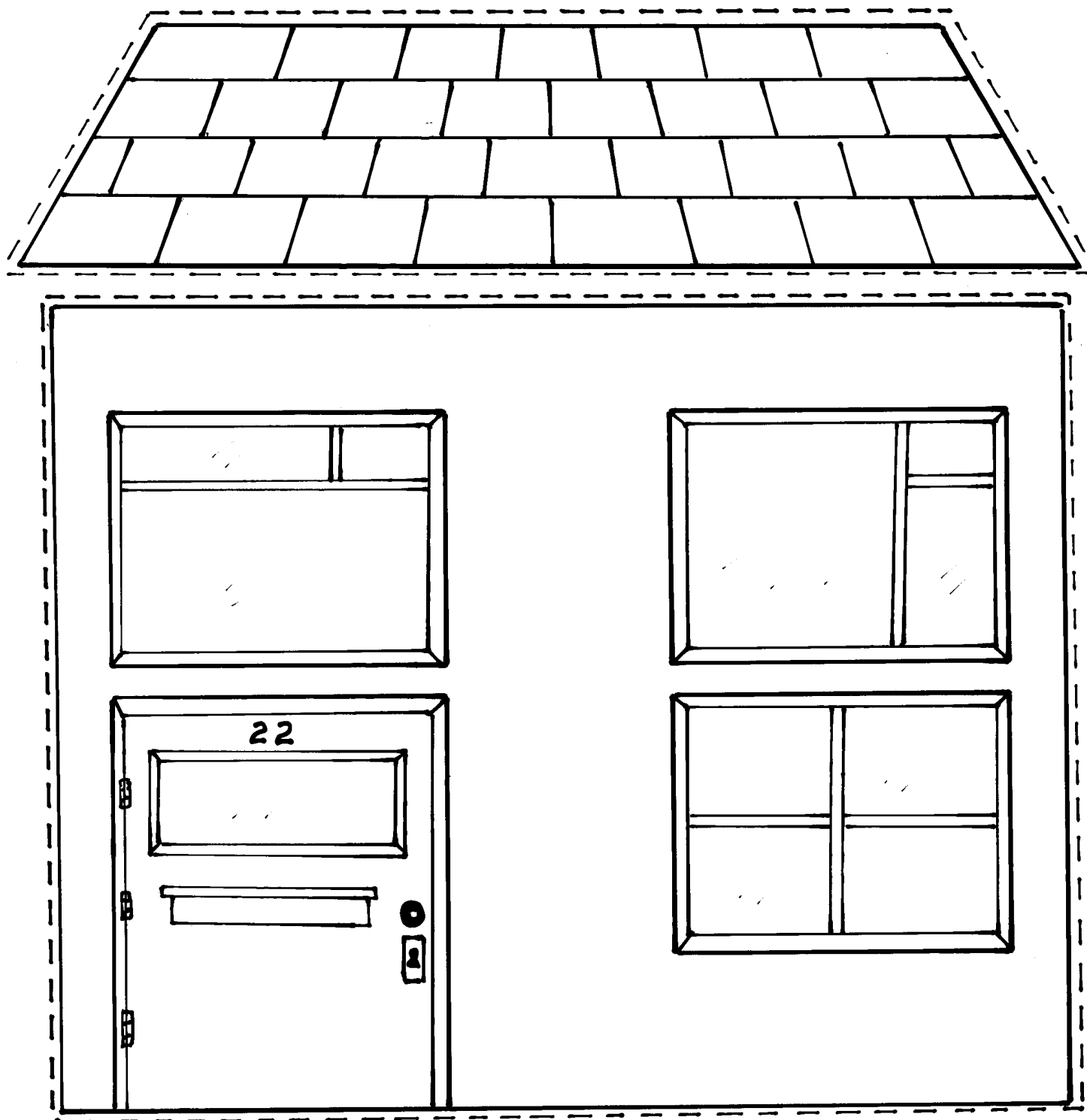
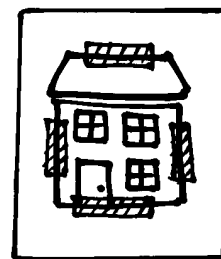

Cut out box and lid. Place box on a sheet of A4 card/paper. Tape along bottom and side edges. Place lid on box, and tape along top edge only. The lid will then lift to allow pictures to be posted in the box.

